

# MAGNETIC SHIELDED SURFACE-MOUNT POWER INDUCTORS FASDRH6D28-6D38 SERIES



## FEATURES:

- Magnetically Shielded Structure
- Low DC Resistance
- Large current up to 3.2A
- Excellent Mechanical Strength
- High Reliability and Excellent Solderability
- Low and square Profile
- High heat resistance

## OPTIONS:

- Packaging:Tape & Reel is standard (Qty:2000pcs)
- Bulk packaging available for smaller quantities
- Tolerance:10% and 5% is standard tighter tolerances available

## COMMON APPLICATIONS:

- VCRs, Notebook, DC/DC Converters
- Video Digital Cameras
- Communication System
- Automotive Systems Power supplier
- LCD PDP Televisions
- Hard Disk Drives, Topset, XDSL
- Network Systems
- Computer Peripheral Equipment

## ELECTRICAL CHARACTERISTICS

Part Number	L $\mu$ H	Test Freq KHz	DCR ohm Max	IDC Max A	Part Number	L $\mu$ H	Test Freq KHz	DCR ohm Max	IDC Max A
FASDRH6D28-3R0N	3.0	10	24	3.00	FASDRH6D38-3R3N	3.3	10	20	3.20
FASDRH6D28-3R9N	3.9	10	27	2.60	FASDRH6D38-5R0N	5.0	10	24	2.60
FASDRH6D28-5R0N	5.0	10	31	2.40	FASDRH6D38-6R2N	6.2	10	27	2.30
FASDRH6D28-6R0N	6.0	10	35	2.25	FASDRH6D38-7R4N	7.4	10	31	2.10
FASDRH6D28-7R3N	7.3	10	54	2.10	FASDRH6D38-8R7N	8.7	10	34	2.00
FASDRH6D28-8R6N	8.6	10	58	1.85	FASDRH6D38-100N	10	10	44	1.80
FASDRH6D28-100N	10	10	65	1.70	FASDRH6D38-120N	12	10	53	1.70
FASDRH6D28-120N	12	10	70	1.55	FASDRH6D38-150N	15	10	57	1.45
FASDRH6D28-150N	15	10	84	1.40	FASDRH6D38-180N	18	10	92	1.40
FASDRH6D28-180N	18	10	95	1.32	FASDRH6D38-220N	22	10	96	1.20
FASDRH6D28-220N	22	10	128	1.20	FASDRH6D38-270N	27	10	109	1.10
FASDRH6D28-270N	27	10	142	1.05	FASDRH6D38-330N	33	10	124	1.00
FASDRH6D28-330N	33	10	165	0.97	FASDRH6D38-390N	39	10	138	0.95
FASDRH6D28-390N	39	10	210	0.86	FASDRH6D38-470N	47	10	155	0.85
FASDRH6D28-470N	47	10	238	0.80	FASDRH6D38-560N	56	10	202	0.75
FASDRH6D28-560N	56	10	277	0.73	FASDRH6D38-680N	68	10	234	0.70
FASDRH6D28-680N	68	10	304	0.65	FASDRH6D38-820N	82	10	324	0.62
FASDRH6D28-820N	82	10	390	0.60	FASDRH6D38-101N	100	10	358	0.58
FASDRH6D28-101N	100	10	535	0.54					

Note:1. K=±10%,M=±20%,N=±30%

## TECHNICAL INFORMATION & PHYSICAL CHARACTERISTICS:

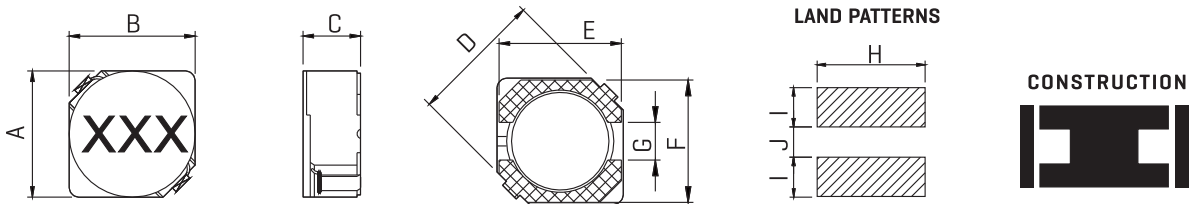

Induc ance Testing: HP4284A [Equivalent acceptable]  
 DCR:QuadTech 1880 Milliohmmer  
 Q- HP4342A - SRF-HP4191A  
 IDCMax current is decreased 10% against its initial value  
 Operating temperature: -40°C to +105°C  
 Storage Temperature: -40°C to +105°C  
 Solder methods: Vapor Phase,Infrared Reflow  
 Resistance to soldering heat:260°C for 10 seconds  
 Solvent resistance: Conforms to MIL-STD-202E  
 Marking: Inductance & Tolerance  
 Note:All specifications subject to change without notice.

### DIMENSIONS IN: mm

Part number	A	B	C	D	E	F	G	H	I	J
FASDRH6D28	7.0Max	7.0Max	3.2Max	9.5Max	6.5	6.5	2.0	7.3	2.65	2.0
FASDRH6D38	7.0Max	7.0Max	4.2Max	9.5Max	6.5	6.5	2.0	7.3	2.65	2.0