

AC CURRENT TRANSFORMER FACT104P-CT105W SERIES



FEATURES:

Low profile, directly to PCB
PBT 94VD Case
burn-resistant epoxy resin, stable

APPLICATION:

Power Meter Class 0.2, 0.5, and 1.0 for accurate measurement, Indirect and Direct Type
Power Calibrator and Transducer
Street Lighting Control System
Monitoring and Protection Relay
Ground Fault CT or Grounded Neutral Sensor
Current & Power Measurement
High-end Digital Protection Relay
High-end Industrial Power Sensor

CHARACTERISTICS:

Rated Current: 0.1A-200A
Accuracy: 0.1 Class
Phase Shift Change: 12° during 2% -120% Ib
Linearity: 0.1L, 0.2L
Operation frequency: 20Hz-10KHz
Operation Temperature: -40°C to +80°C
Hi-pot Test between Primary and Secondary: 4KV/1min
Insulation Resistance: 500Mohm[500VDC]

ELECTRICAL CHARACTERISTICS:

Mode No.	Current (A)	Turns Ratio	DC Resistance (ohms)	Inductance (50Hz/0.5V) (H)	FIG
FACT104P	100	1:2500	113±15%	340±30%	FIG1
FACT105P	120	1:2500	113±15%	340±30%	FIG1
FACT006W-C1	6	1:2000	95±15%	160±30%	FIG2
FACT010W-C1	10	1:2500	125±15%	250±30%	FIG2
FACT100W-C	40	1:2000	95±15%	160±30%	FIG2
FACT100W-C1	40	1:2500	125±15%	250±30%	FIG2
FACT020W-C2	20	1:2000	95±15%	160±30%	FIG3
FACT101W-C1	60	1:2000	95±15%	160±30%	FIG3
FACT104W	100	1:2000	113±15%	340±30%	FIG4
FACT105W	120	1:2000	113±15%	340±30%	FIG4

SHAPE AND DIMENSIONS

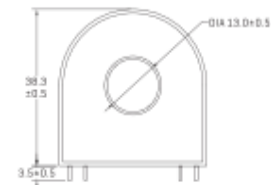
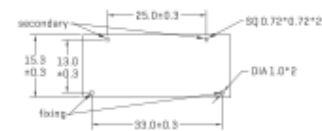

FIG 1

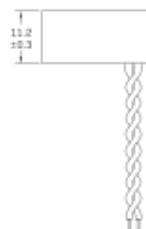
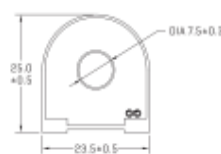

FIG 2

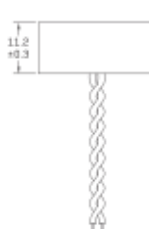
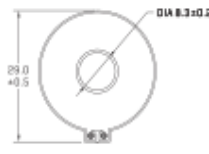

FIG 3

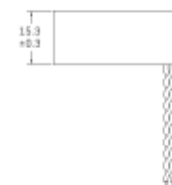
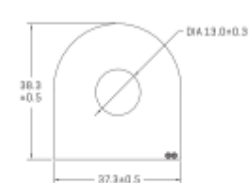

FIG 4

DIMENSIONS:MM