

## SPECIFICATION FOR APPROVAL

### Material

Production:	Neu Flux Cores
FUAN.P/N:	KNF106-075A-E18
AL:	151(nH/N <sup>2</sup> )±8%
Material:	75 μ
Coating Color:	Brown
Coating material:	epoxy
Coating Breakdown Voltage:	1000V, 0.5mA, 2Sec

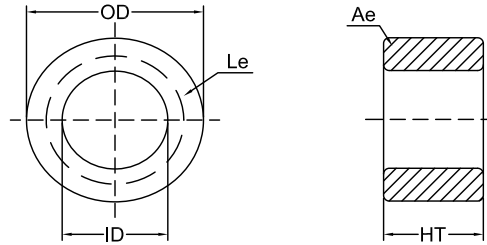

### Physical Characteristics

Before Coating			After Coating			Le(cm)	Ae(cm <sup>2</sup> )	V(cm <sup>3</sup> )	W(cm <sup>2</sup> )	Weight (g) (ref.)	Box Quantity (Pieces)
OD(Max.) in/mm	ID(Min.) in/mm	Ht(Max.) in/mm	OD(Max.) mm	ID(Min.) mm	Ht(Max.) mm						
1.059 26.90	0.579 14.70	0.709 18.00	27.70	14.10	19.00	6.350	1.051	6.670	1.561	48.0	280

### Electrical Parameters(Typical)      Temperature(25°C±2°C)

Test Item	Test Condition	Value(Typical)	Test Instrument
Inductance	φ0.80mm/34Ts, 20kHz/1V, I=0A (Evenly full windings)	174.6μH±8%	CH3302
DC-Bias	φ0.80mm/34Ts, 20kHz/1V, I=15A(H=100Oe) (Evenly full windings)	93.2μH(Min.)	WK3255B+WK3265B
Core Loss	50kHz/1000Gs	600mW/cm <sup>3</sup> (Max.)	SY-8219
Remarks	Set the internal resistance of LCR meter to 100Ω.		

### Core Loss Curves(Typical)

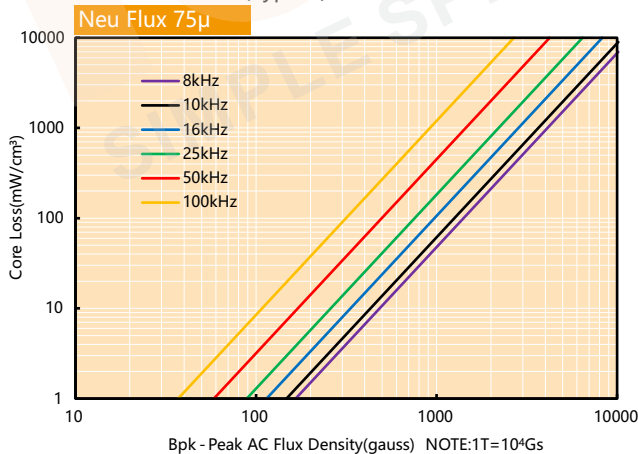

### DC-Bias Curves(Typical)

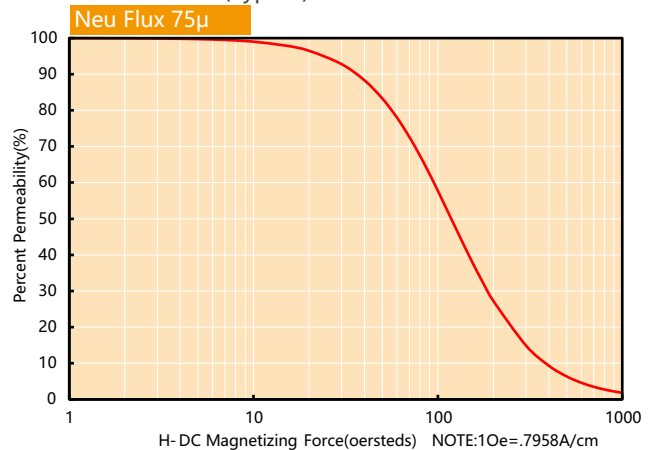

Neu Flux Cores are made of 85% Fe & 15% Si-Ni alloy powder; Its saturation flux density is 16000Gs, permeability is around 26u-90u, the loss is about half of Si-Fe cores, similar to High flux cores, the DC offset performance is better than Si-Fe cores, same as High flux cores, which is a low-cost material can replace High flux cores; Meantime, it is also an ideal substitute for Amorphous powder cores. Moreover, it has excellent temperature stability and high energy storage capacity also solve the noise problem of Amorphous powder cores.