

## SMD SHUNT

### FASE SERIES



#### FEATURES

- Excellent Long Term Stability
- Element Material Temperature Coefficient  $\leq 50\text{ppm}/^\circ\text{C}$
- Comply With RoHS Standards
- Special Specifications Can Be Customized
- Electron Beam Welding, Stable Performance
- High Overload Capacity
- Resistance Values Down to  $0.2\sim 0.5\text{m}\Omega$
- AEC-Q200 Test

#### APPLICATIONS

- Frequency Converters
- Power Modules
- Uninterrupted Power Supply
- Current Sensor for Power Hybrid Applications
- Welding Equipment
- Electronic Battery Management
- High Current Applications For the Automotive Market
- Automatic Control Power Supply

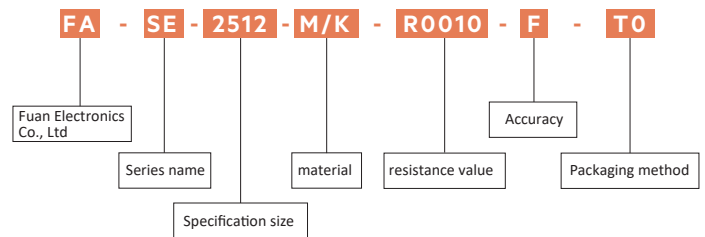

#### ELECTRICAL CHARACTERISTICS FORM

Part Number	Power	Resistance	Accuracy
FASE-2512-M/K	3W	1mΩ	0.5%,1%,2%,5%
FASE-3921-M/K	5W	0.3~5 mΩ	0.5%,1%,2%,5%
FASE-5931-M/K	7W	0.2~5 mΩ	0.5%,1%,2%,5%

# Product datasheet

## ELECTRICAL INFORMATION

Dimension in mm

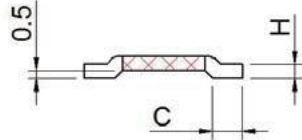
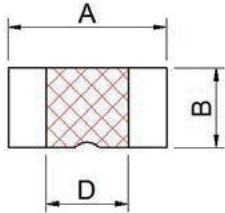

Solder Pad Type

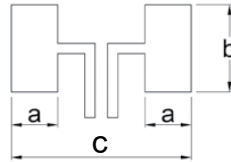

Tape & Reel Information

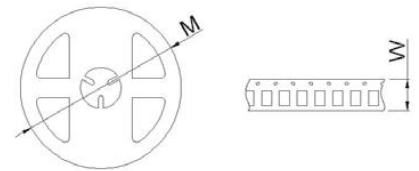

Item	A±0.2	B±0.2	C±0.2	D±0.2	H±0.2
FASE-2512-M/K	6.35	3.05	1.15	3.0	0.5
FASE-3921-M/K	10/10.4	5.2	2.0	5.2	0.28~1.66
FASE-5931-M/K	15	7.75	4.0	6.2	0.29~2.0

Item	a	b	c	M	W	QTY
FASE-2512	1.8	3.4	7	330	15.9	5000
FASE-3921	2.7	6.2	11	330	23.8	3000
FASE-5931	5.2	8.75	16	330	23.8	2000

## Derating Curve Resistance Change VS Temperature

